



US Army Corps
of Engineers
Seattle District



WASHINGTON STATE
DEPARTMENT OF
ECOLOGY

Joint Public Notice

Application for a Department of the Army Permit and a Washington Department of Ecology Water Quality Certification and/or Coastal Zone Management Consistency Concurrence

US Army Corps of Engineers
Regulatory Branch
Post Office Box 3755
Seattle, WA 98124-3755
Telephone: (206) 316-3893
ATTN: Mr. Ron Wilcox,
Project Manager

WA Department of Ecology
SEA Program
Post Office Box 47600
Olympia, WA 98504-7600
Telephone: (360) 407-6068
ATTN: SEA Program,
Federal Permit Coordinator

Public Notice Date: July 8, 2014
Expiration Date: August 7, 2014

Reference No.: NWS-2013-1283
Name: Shell Oil Product US,
Puget Sound Refinery

Interested parties are hereby notified that the U.S. Army Corps of Engineers (Corps) and the Washington Department of Ecology (Ecology) have received an application to perform work in waters of the U.S. as described below and shown on the enclosed drawings dated December 6, 2013.

The Corps will review the work in accordance with Section 404 of the Clean Water Act (CWA) and Section 10 of the Rivers and Harbors Act. Ecology will review the work pursuant to Section 401 of the CWA, with applicable provisions of State water pollution control laws and the Coastal Zone Management Act.

APPLICANT: Shell Oil Products US, Puget Sound Refinery
Attention: Mr. Brian Rhodes
P.O. Box 622
Anacortes, Washington 98221-0622
Telephone: (360) 293-1761

AGENT: URS Corporation
Attention: Mr. Jeff Walker
1501 4th Avenue
Suite 1400
Seattle, Washington 98101-1616
Telephone: (206) 438-2351

LOCATION: Shell Puget Sound Refinery, near Anacortes, Skagit County, Washington.

WORK: The proposed project would construct a rail spur and crude oil loading/unloading facility with appurtenant features. The work would excavate and discharge fill material into 25.29 acres of a mix forested, scrubshrub and emergent wetlands, convert 0.41 acres of forested wetland to emergent wetlands, and temporarily impact up to 6.98 acres of emergent, scrubshrub wetlands. Up to 175 linear feet of stream would be rerouted and sections of up to 10 ditches would be placed in culverts or rerouted. Approximately 237,000 cubic yards of material would be excavated to construct an approximately 5,000-foot-long trench for the required rail grade and spill containment pad. The work would require approximately 8,500 cubic yards of fill material to construct the railbed and other related project elements.

NWS-2013-1283, Shell Oil Products US, Puget Sound Refinery

PURPOSE: To provide the existing Shell Puget Sound Refinery (PSR) the capability to receive crude oil via rail from oil fields in the mid-continent of the U.S. to maintain current oil supply.

ADDITIONAL INFORMATION: The Shell PSR currently receives crude oil by ship from Alaska's North Slope. This crude oil supply has experienced long term decline in production. The crude brought in by rail intends to replace some oil supply currently brought in by ship to maintain current production. The crude by rail shipments would consist of approximately one unit train per day, approximately six unit trains per week. Each unit train would include four locomotives and approximately 102 oil tank cars; each car would hold approximately 742 barrels of crude oil. The existing rail facilities at the PSR are not designed to receive and unload crude by rail shipments.

The proposed rail spur would connect to the existing BNSF Railway Company's mainline, also known as the Anacortes Subdivision, starting from the BNSF mainline adjacent to South March Road and terminate near North Texas Road. The existing BNSF mainline and siding track would be relocated approximately 50 feet to the south. A 1,000-foot-long section of drainage ditch located between South March Road and the BNSF mainline would be placed in a culvert to allow for the rail relocation.

The spur would consist of an arrival track (approximately 7,200-foot long), a departure track (approximately 7,100 feet long), an unloading track parallel to the arrival track (approximately 4,000 feet long), two bad order (BO) tracks (for rail car service and maintenance; BO track 1 would be approximately 950 feet long, and BO 2 would be approximately 800 feet long).

Additional project elements would include a 3.28-acre oil/water concrete containment pad, an approximately 3,200-foot-long loading platform, two stormwater control basins (3.49-acre north basin, 1.49-acre south basin), one 82,000-cubic-foot oily water basin, operations shelter, storage shed, utility services, a perimeter access/maintenance road, oil piping and pumping stations, fire control services, relocating Puget Sound Energy Power lines, and relocating sections of the Olympic Pipeline and the Kinder Morgan Pipeline.

Copies of this public notice which have been mailed or otherwise physically distributed feature project drawings in black and white. To access the electronic version of this public notice, go to the Seattle District's web page at <http://www.nws.usace.army.mil/> and under the heading Open Public Comment Periods select Regulatory Public Notices. Recently-issued public notices are listed in chronological order of the date of issuance. Select and view the listing for this project.

The wetland boundaries and line of mean high water shown on the project drawings have not yet been verified by the Corps. If the Corps determines the boundaries of the wetland/waters are substantially inaccurate a new public notice may be published.

MITIGATION: Compensatory mitigation will be required for the impacts to waters of the U.S., 14.7 acres of permanent impacts to wetland buffers and 4.47 acres of temporary wetland impacts.

The applicant has proposed purchasing mitigation bank credits at a certified mitigation bank in Skagit County to meet compensatory mitigation requirements. Other compensatory mitigation may include onsite wetland enhancement or restoration.

ENDANGERED SPECIES: The Endangered Species Act (ESA) requires federal agencies to consult with the National Marine Fisheries Service (NMFS) and/or U.S. Fish and Wildlife Service pursuant to Section 7 of the ESA on all actions that may affect a species listed (or proposed for listing) under the ESA as threatened or endangered or any designated critical habitat. A preliminary determination indicates that the activity will affect endangered or threatened species, or their critical habitat. Consultation under Section 7 of the ESA is required.

NWS-2013-1283, Shell Oil Products US, Puget Sound Refinery

If the Corps determines that the proposed action may adversely affect EFH for federally managed fisheries in Washington waters, the Corps will initiate EFH consultation with the NMFS. The Corps' final determination relative to project impacts and the need for mitigation measures is subject to review by and coordination with the NMFS.

CULTURAL RESOURCES: The Corps will review the latest published version of the National Register of Historic Places, lists of properties determined eligible and other sources of information. The Corps invites responses to this public notice from Native American Tribes or tribal governments; Federal, State, and local agencies; historical and archeological societies; and other parties likely to have knowledge of or concerns regarding historic properties and sites of religious and cultural significance at or near the project area. After receipt of comments from this public notice, the Corps will evaluate potential impacts and consult with the State Historic Preservation Officer and Native American Tribes in accordance with Section 106 of the National Historic Preservation Act, as appropriate.

EVALUATION – CORPS: The decision whether to issue a permit will be based on an evaluation of the probable impacts, including cumulative impacts, of the proposed activity on the public interest. That decision will reflect the national concern for both protection and utilization of important resources. The benefits, which reasonably may be expected to accrue from the proposal, must be balanced against its reasonably foreseeable detriments. All factors which may be relevant to the proposal will be considered, including the cumulative effects thereof; among those are conservation, economics, aesthetics, general environmental concerns, wetlands, historic properties, fish and wildlife values, flood hazards, floodplain values, land use, navigation, shoreline erosion and accretion, recreation, water supply and conservation, water quality, energy needs, safety, food and fiber production, mineral needs, considerations of property ownership, and, in general, the needs and welfare of the people.

The Corps is soliciting comments from the public; Native American Nations or tribal governments; Federal, State, and local agencies and officials; and other interested parties in order to consider and evaluate the impacts of this activity. Any comments received will be considered by the Corps to determine whether to issue, modify, condition or deny a permit for the work. To make this decision, comments are used to assess impacts on endangered species, historic properties, water quality, general environmental effects, and the other public interest factors listed above. Comments are used in the preparation of an Environmental Assessment and/or an Environmental Impact Statement pursuant to the National Environmental Policy Act. Comments are also used to determine the need for a public hearing and to determine the overall public interest of the activity.

The described discharge will be evaluated for compliance with guidelines promulgated by the Environmental Protection Agency under authority of Section 404(b)(1) of the CWA. These guidelines require an alternatives analysis for any proposed discharge of dredged or fill material into waters of the United States.

SOURCE OF FILL MATERIAL: The source of the fill material will be from clean excavated material on site.

EVALUATION – ECOLOGY: Ecology is soliciting comments from the public; Federal, Native American Nations or tribal governments, State, and local agencies and officials; and other interested parties in order to consider and evaluate the impacts of this activity. Ecology will be considering all comments to determine whether to certify or deny certification for the proposed project.

ADDITIONAL EVALUATION: This proposal is the subject of a Shorelines Substantial Development Permit being processed by Skagit County.

COMMENT AND REVIEW PERIOD: Conventional mail or e-mail comments on this public notice will be accepted and made part of the record and will be considered in determining whether it would be in the public

NWS-2013-1283, Shell Oil Products US, Puget Sound Refinery

interest to authorize this proposal. In order to be accepted, e-mail comments must originate from the author's e-mail account and must include on the subject line of the e-mail message the permit applicant's name and reference number as shown below. Either conventional mail or e-mail comments must include the permit applicant's name and reference number, as shown below, and the commentator's name, address, and phone number. All comments whether conventional mail or e-mail must reach this office, no later than the expiration date of this public notice to ensure consideration.

CORPS COMMENTS: All e-mail comments should be sent to ronald.j.wilcox@usace.army.mil. Conventional mail comments should be sent to: U.S. Army Corps of Engineers, Regulatory Branch, Attention: Mr. Ron Wilcox, P.O. Box 3755, Seattle, Washington 98124-3755. All comments received will become part of the administrative record and are subject to public release under the Freedom of Information Act including any personally identifiable information such as names, phone numbers, and addresses.

ECOLOGY COMMENTS: Any person desiring to present views on the project pertaining to a request for water quality certification under Section 401 of the CWA and/or Coastal Zone Management consistency concurrence, may do so by submitting written comments to the following address: Washington State Department of Ecology, Attention: Federal Permit Coordinator, P.O. Box 47600, Olympia, Washington 98504-7600, or e-mail to ecyrefedpermits@ecy.wa.gov.

To ensure proper consideration of all comments, responders must include the following name and reference number in the text of their comments: Shell Oil Products US, Puget Sound Refinery; NWS-2013-1283

Encl: Figures (18)

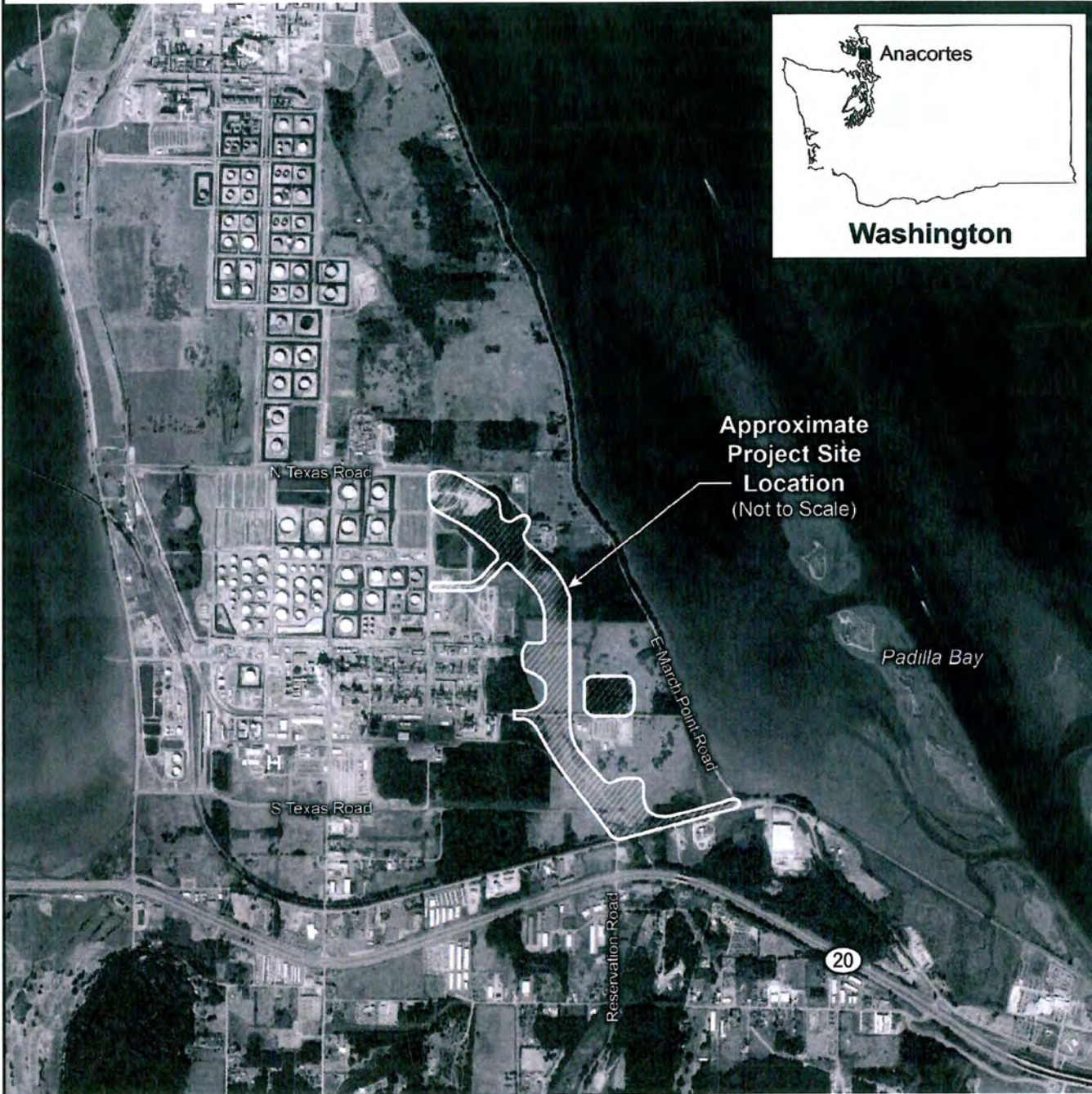

NOT TO SCALE

SHEET 1
PROJECT SITE LOCATION

Applicant: Shell

Reference Number:

Adjacent Property Owners:
See Attachment C

NWS-2013-1283

Project Address: 8505 South Texas Road
Anacortes, WA 98221

Lat/Long: Start: 48N-27-57, 122W-32-14
End: 48N-28-41, 122W-33-14

Datum: Horizontal datum based on
'Shell Anacortes Refinery'
local coordinate grid.
Vertical Datum NAVD88.

Sheet: 1 of 18 **Date:** 12/6/2013

Proposed Project:
Crude by Rail East Gate

In: Wetlands

Near/At: Anacortes (Shell Puget Sound Refinery)

County: Skagit

State: WA

J:\GIS\Projects\Shell\Puget Sound Refinery\SubTasks\Crude Rail\WetlandMitigation\JARPA\Sheet 01 (Site Location Plan).dwg
Mod: 03/13/2014, 16:35 | Plotted: 03/17/2014, 15:41

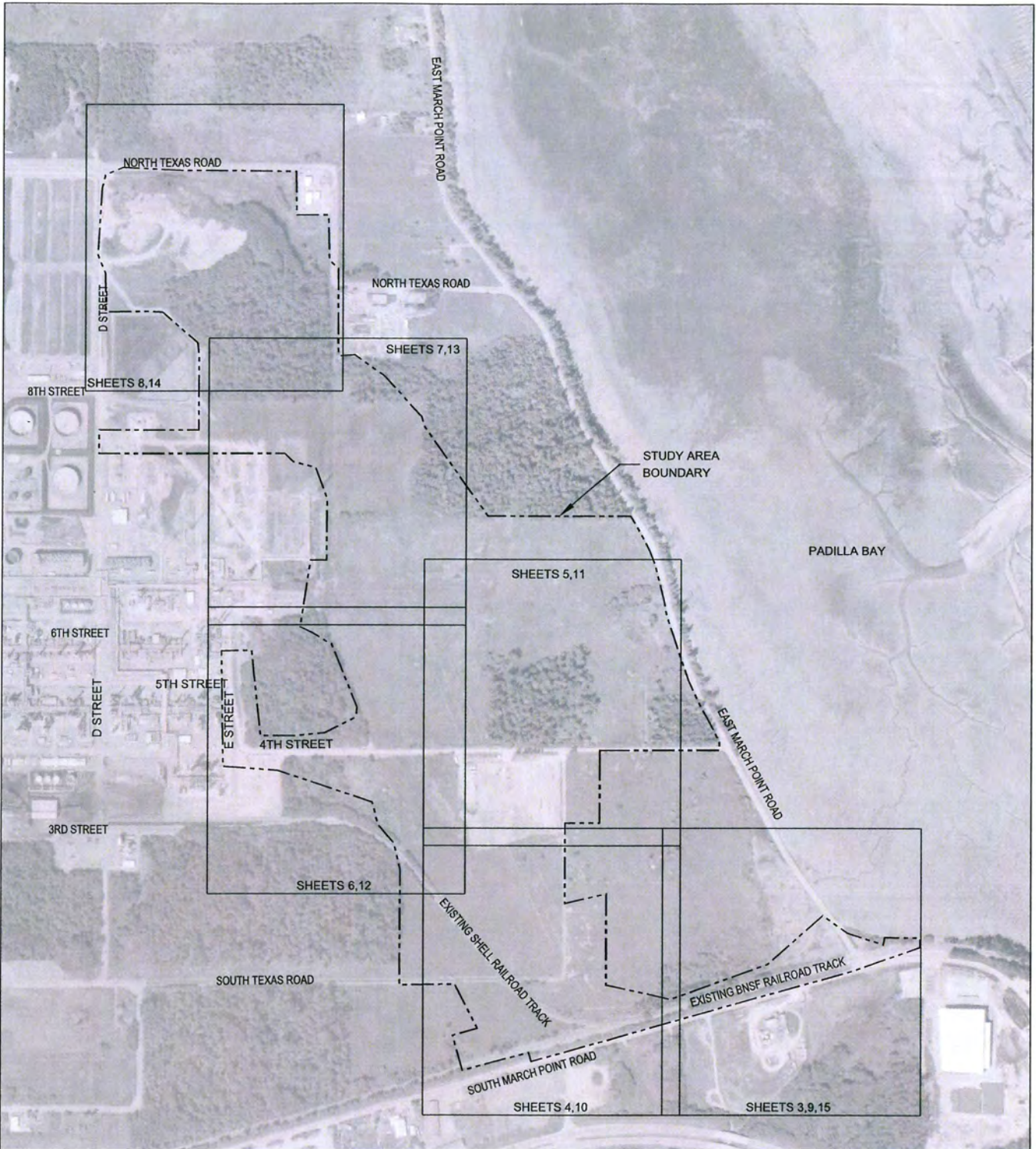

LEGEND
 WETLAND
 STUDY AREA
 BOUNDARY

**SHEET 2
 SHEET PLAN**

Applicant: Shell
Reference Number:
Adjacent Property Owners:
 See Attachment C

Project Address: 8505 South Texas Road
 Anacortes, WA 98221
Lat/Long: Start: 48N-27-57, 122W-32-14
 End: 48N-28-41, 122W-33-14
Datum: Horizontal datum based on
 'Shell Anacortes Refinery'
 local coordinate grid.
 Vertical Datum NAVD88.
Sheet: 02 of 18 **Date:** 12/10/2013

Proposed Project:
 Crude by Rail East Gate
In: Wetlands
Near/At: Anacortes (Shell Puget Sound Refinery)
County: Skagit
State: WA

NWS-2013-1283

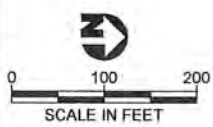
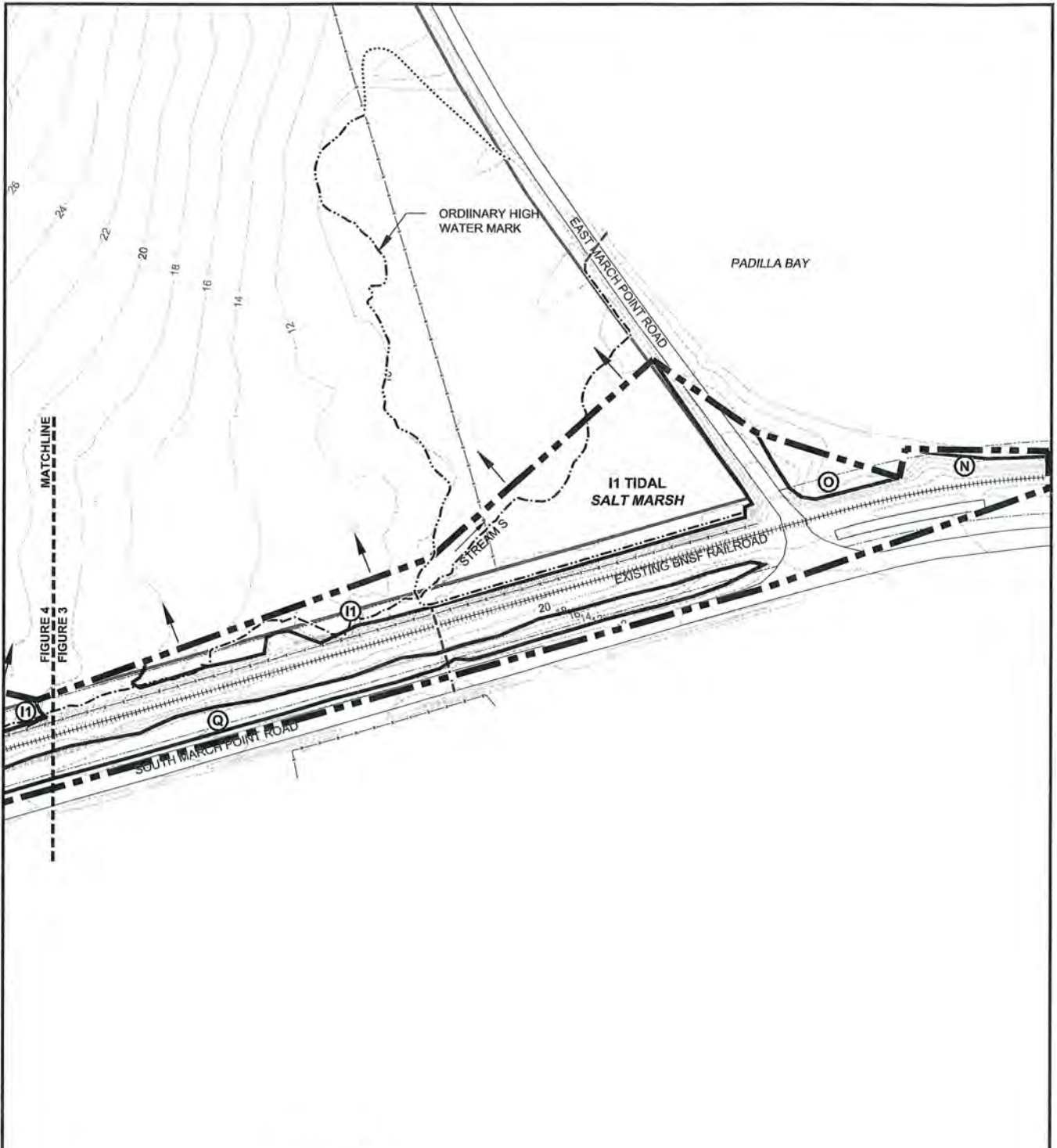

- LEGEND**
- WETLAND
 - DITCH/STREAM/SWALE
 - CULVERT
 - WETLAND STUDY AREA BOUNDARY
 - WETLAND CONTINUES BEYOND STUDY AREA BOUNDARY

SHEET 3
EXISTING CONDITIONS PLAN

<p>Applicant: Shell</p> <p>Reference Number:</p> <p>Adjacent Property Owners: See Attachment C</p> <p>NWS-2013-1283</p>	<p>Project Address: 8505 South Texas Road Anacortes, WA 98221</p> <p>Lat/Long: Start: 48N-27-57, 122W-32-14 End: 48N-28-41, 122W-33-14</p> <p>Datum: Horizontal datum based on 'Shell Anacortes Refinery' local coordinate grid. Vertical Datum NAVD88.</p> <p>Sheet: 3 of 18 Date: 12/6/2013</p>	<p>Proposed Project: Crude by Rail East Gate</p> <p>In: Wetlands</p> <p>Near/At: Anacortes (Shell Puget Sound Refinery)</p> <p>County: Skagit</p> <p>State: WA</p>
---	---	---

J:\GIS\Projects\SHELL\IPUG\et Sound Refinery\SubTasks\Crude Rail\Wetland\Mitigation\JARPA\Sheet 03-08 (Existing Cond Plans).dwg
 Mod: 03/17/2014, 11:25 | Plotted: 03/17/2014, 15:44

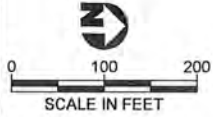
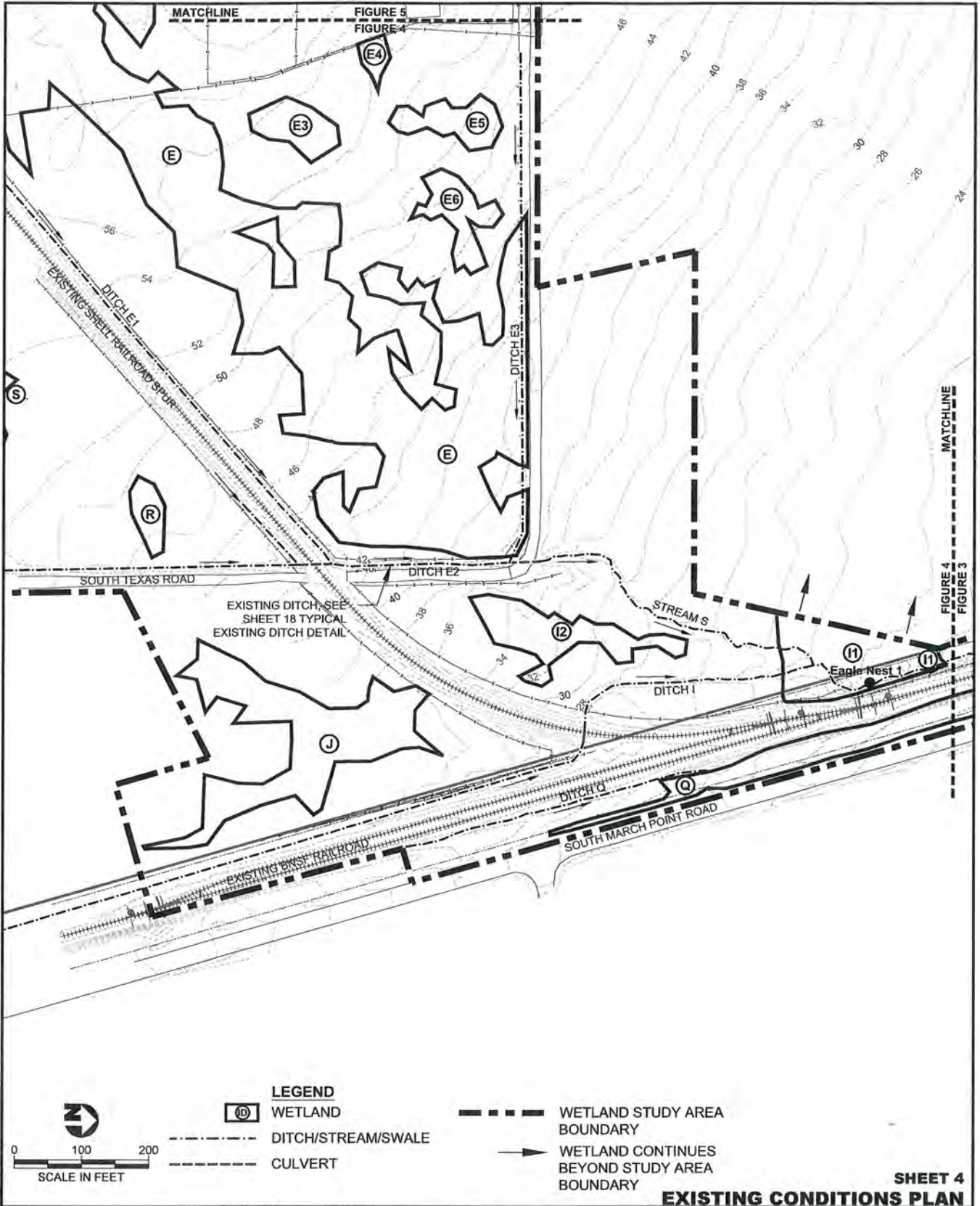

- LEGEND**
- W WETLAND
 - - - - - DITCH/STREAM/SWALE
 - - - - - CULVERT
 - - - - - WETLAND STUDY AREA BOUNDARY
 - WETLAND CONTINUES BEYOND STUDY AREA BOUNDARY

SHEET 4
EXISTING CONDITIONS PLAN

<p>Applicant: Shell</p> <p>Reference Number:</p> <p>Adjacent Property Owners: See Attachment C</p> <p>NWS-2013-1283</p>	<p>Project Address: 8505 South Texas Road Anacortes, WA 98221</p> <p>Lat/Long: Start: 48N-27-57, 122W-32-14 End: 48N-28-41, 122W-33-14</p> <p>Datum: Horizontal datum based on 'Shell Anacortes Refinery' local coordinate grid. Vertical Datum NAVD88.</p> <p>Sheet: 4 of 18 Date: 12/6/2013</p>	<p>Proposed Project: Crude by Rail East Gate</p> <p>In: Wetlands</p> <p>Near/At: Anacortes (Shell Puget Sound Refinery)</p> <p>County: Skagit</p> <p>State: WA</p>
---	---	---

J:\GIS\Projects\SHELL\IP\ugest Sound Refinery\SubTasks\Crude Rail\Wetland\Mitigation\JARRP\Sheet 03-08 (Existing Cond Plans).dwg
 Mod: 03/17/2014, 11:25 | Plotted: 03/17/2014, 15:44

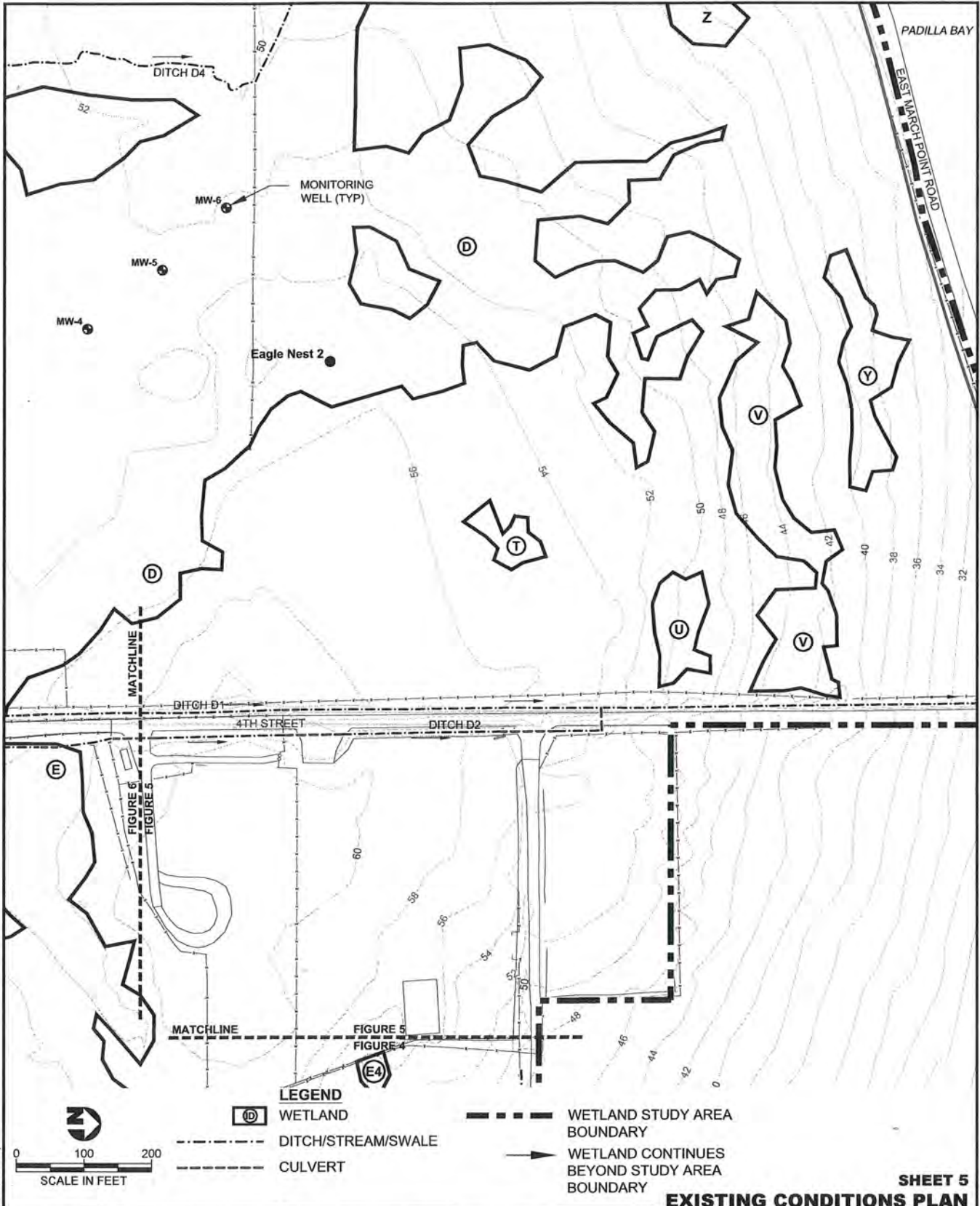

**SHEET 5
EXISTING CONDITIONS PLAN**

Applicant: Shell

Reference Number:

Adjacent Property Owners:
See Attachment C

NWS-2013-1283

Project Address: 8505 South Texas Road
Anacortes, WA 98221

Lat/Long: Start: 48N-27-57, 122W-32-14
End: 48N-28-41, 122W-33-14

Datum: Horizontal datum based on
'Shell Anacortes Refinery'
local coordinate grid.
Vertical Datum NAVD88.

Sheet: 6 of 18 **Date:** 12/6/2013

Proposed Project:
Crude by Rail East Gate

In: Wetlands

Near/At: Anacortes (Shell Puget Sound Refinery)

County: Skagit

State: WA

J:\GIS\Projects\SHELL\Project Sound Refinery\SubTasks\Crude Rail\Wetland\Mitigation\ARPA\Sheet 03-08 (Existing Cond Plans).dwg
 Mod: 03/17/2014, 11:25 | Plotted: 03/17/2014, 15:44

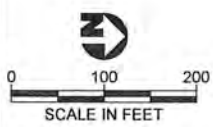
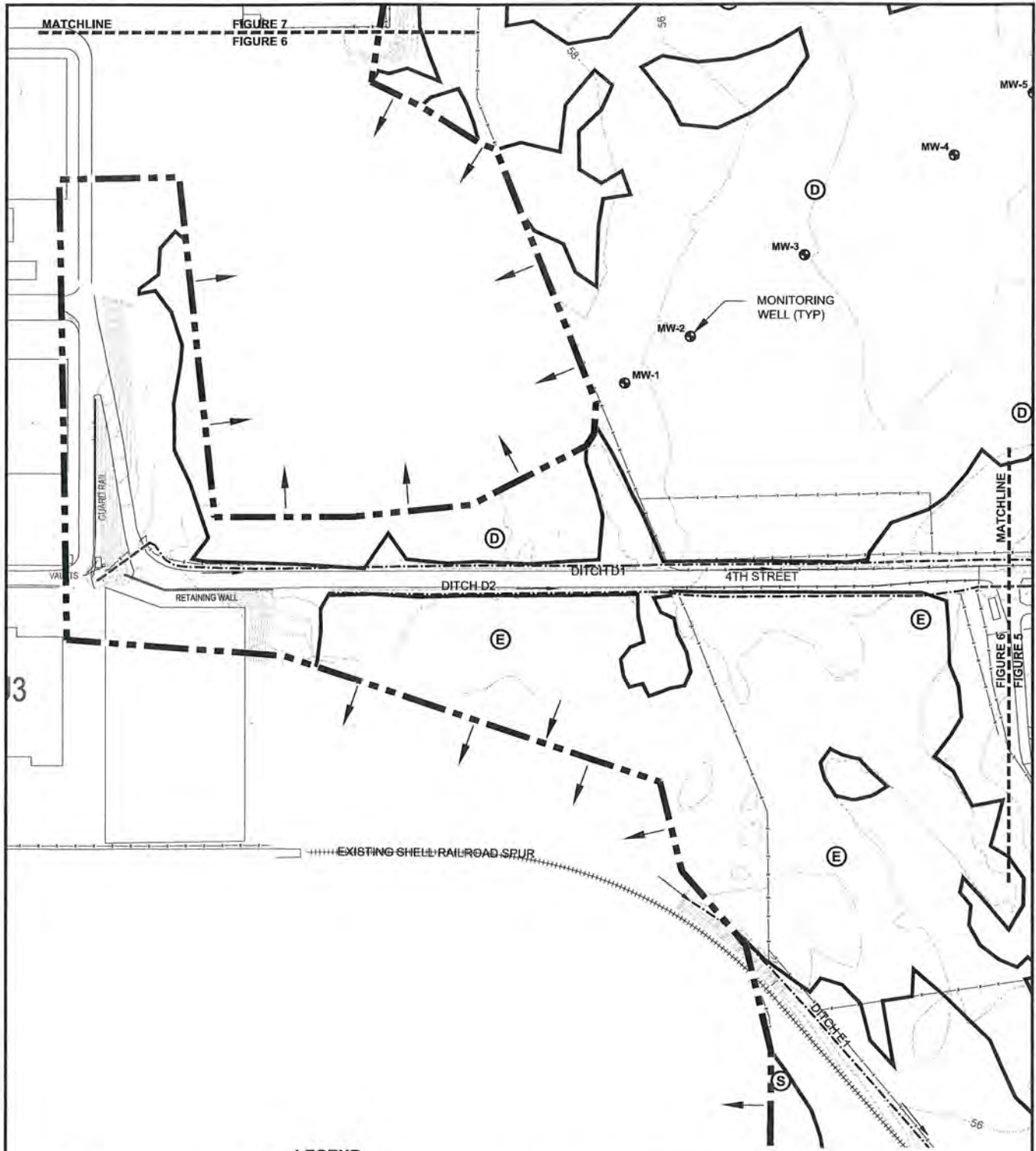

LEGEND	
	WETLAND
	DITCH/STREAM/SWALE
	CULVERT
	WETLAND STUDY AREA BOUNDARY
	WETLAND CONTINUES BEYOND STUDY AREA BOUNDARY

SHEET 6
EXISTING CONDITIONS PLAN

J:\GIS\Projects\SHELL\IP\ugest Sound Refinery\SubTasks\Crude Rail\Wetland\Mitigation\LARPA\Sheet 03-08 (Existing Cond Plans).dwg
 Mod: 03/17/2014, 11:25 | Plotted: 03/17/2014, 15:45

Applicant: Shell
Reference Number:
Adjacent Property Owners:
 See Attachment C
NWS-2013-1283

Project Address: 8505 South Texas Road
 Anacortes, WA 98221
Lat/Long: Start: 48N-27-57, 122W-32-14
 End: 48N-28-41, 122W-33-14
Datum: Horizontal datum based on
 'Shell Anacortes Refinery'
 local coordinate grid.
 Vertical Datum NAVD88.
Sheet: 5 of 18 **Date:** 12/6/2013

Proposed Project:
 Crude by Rail East Gate
In: Wetlands
Near/At: Anacortes (Shell Puget Sound Refinery)
County: Skagit
State: WA

J:\GIS\Projects\Shell\Puget Sound Refinery\SubTasks\Crude Rail\Wetland\Mitigation\ARPA\Sheet 03-08 (Existing Cond Plans).dwg
 Mod: 03/17/2014, 11:25 | Plotted: 03/17/2014, 15:45

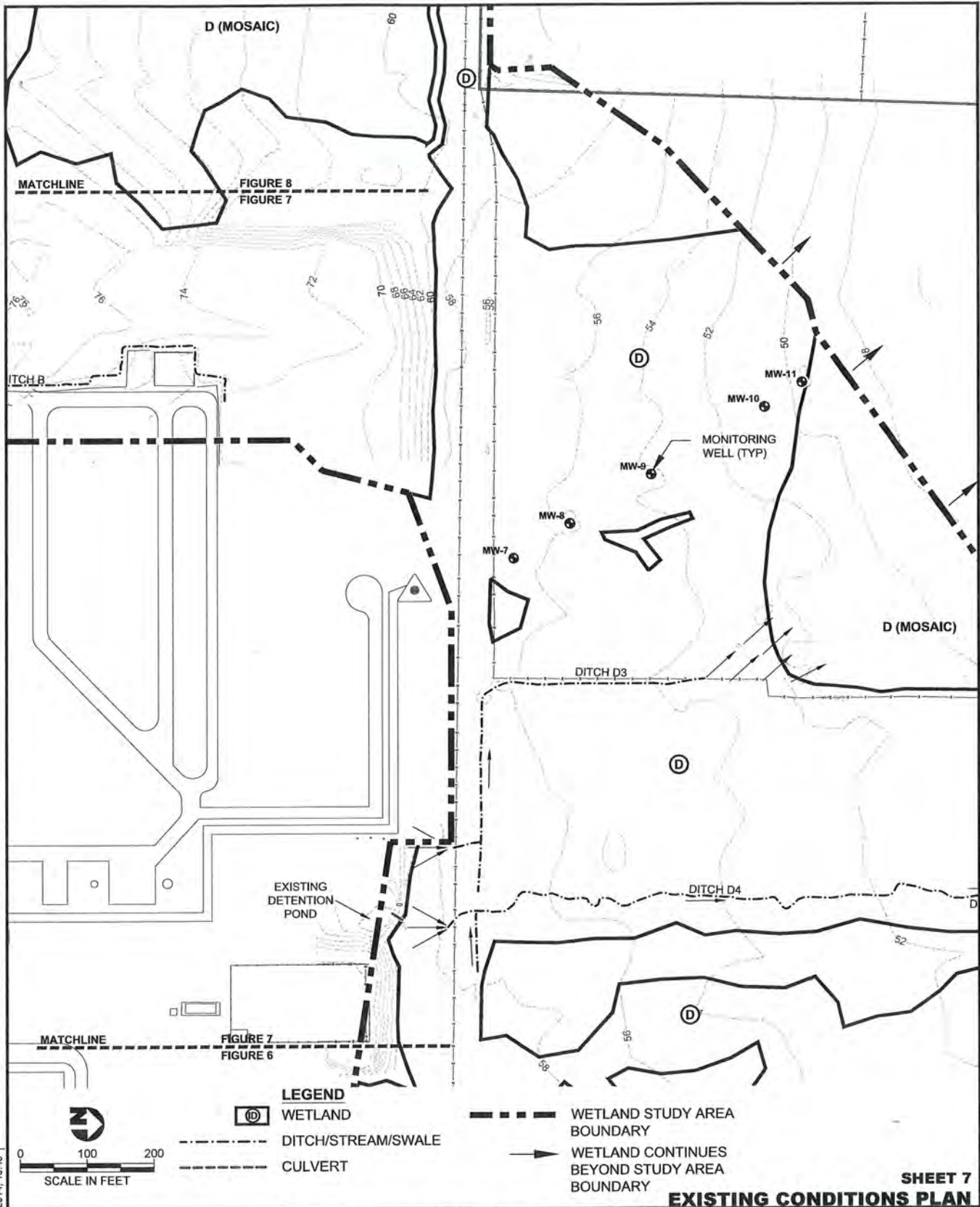

SHEET 7

EXISTING CONDITIONS PLAN

Applicant: Shell
Reference Number:
Adjacent Property Owners:
 See Attachment C
NWS-2013-1283

Project Address: 8505 South Texas Road
 Anacortes, WA 98221
Lat/Long: Start: 48N-27-57, 122W-32-14
 End: 48N-28-41, 122W-33-14
Datum: Horizontal datum based on
 'Shell Anacortes Refinery'
 local coordinate grid.
 Vertical Datum NAVD88.
Sheet: 7 of 18 **Date:** 12/6/2013

Proposed Project:
 Crude by Rail East Gate
In: Wetlands
Near/At: Anacortes (Shell Puget Sound Refinery)
County: Skagit
State: WA

J:\GIS\Projects\Shell\Puget Sound Refinery\Sub Tasks\Crude Rail\Wetland\Mitigation\JARP\Sheet 03-08 (Existing Cond Plans).dwg
 Mod: 03/17/2014, 11:25 | Plotted: 03/17/2014, 15:45

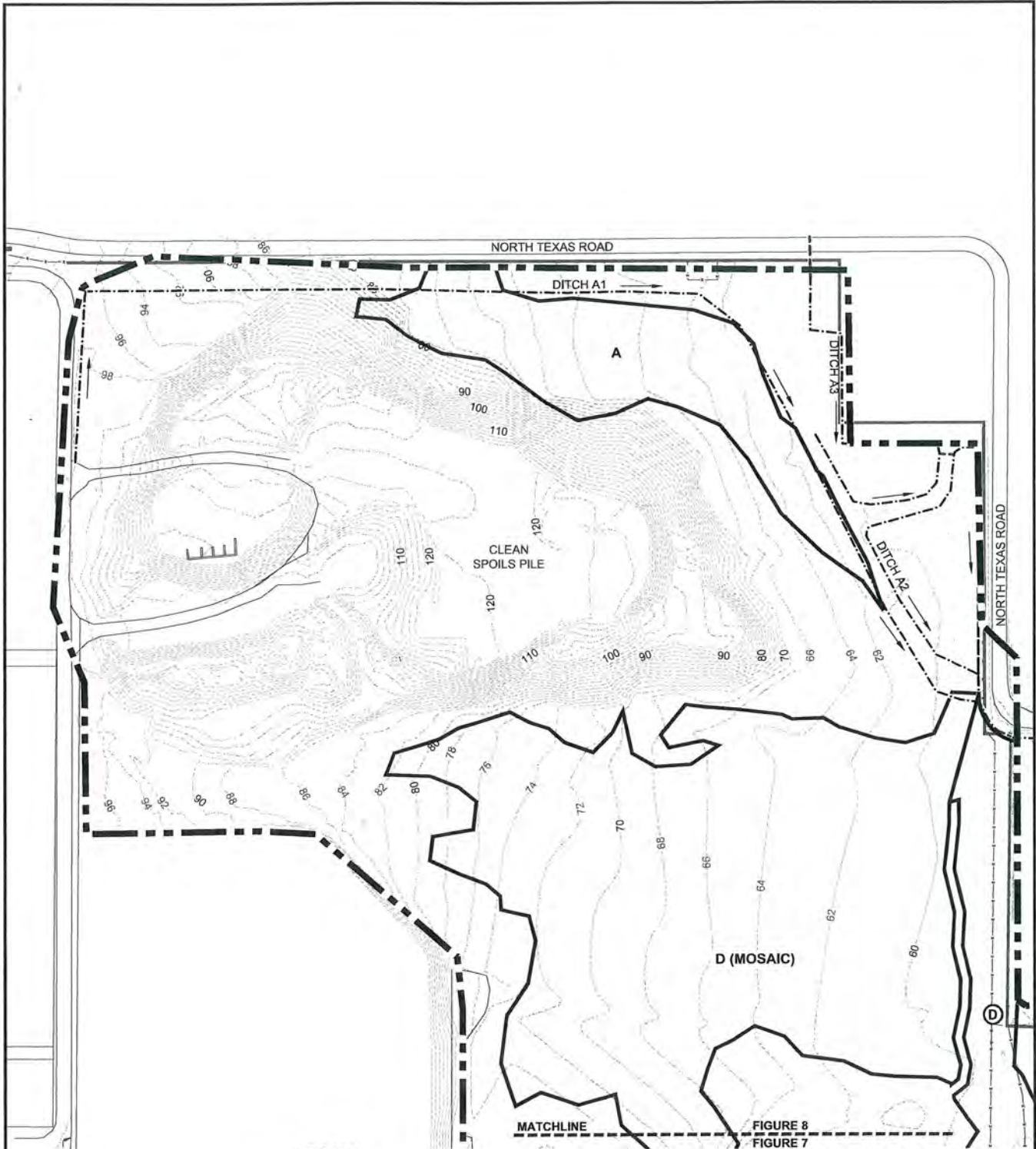

LEGEND

- WETLAND
- DITCH/STREAM/SWALE
- CULVERT
- WETLAND STUDY AREA BOUNDARY
- WETLAND CONTINUES BEYOND STUDY AREA BOUNDARY

SCALE IN FEET: 0 100 200

SHEET 8
EXISTING CONDITIONS PLAN

<p>Applicant: Shell</p> <p>Reference Number:</p> <p>Adjacent Property Owners: See Attachment C</p> <p>NWS-2013-1283</p>	<p>Project Address: 8505 South Texas Road Anacortes, WA 98221</p> <p>Lat/Long: Start: 48N-27-57, 122W-32-14 End: 48N-28-41, 122W-33-14</p> <p>Datum: Horizontal datum based on 'Shell Anacortes Refinery' local coordinate grid. Vertical Datum NAVD88.</p> <p>Sheet: 8 of 18 Date: 12/6/2013</p>	<p>Proposed Project: Crude by Rail East Gate</p> <p>In: Wetlands</p> <p>Near/At: Anacortes (Shell Puget Sound Refinery)</p> <p>County: Skagit</p> <p>State: WA</p>
---	---	---

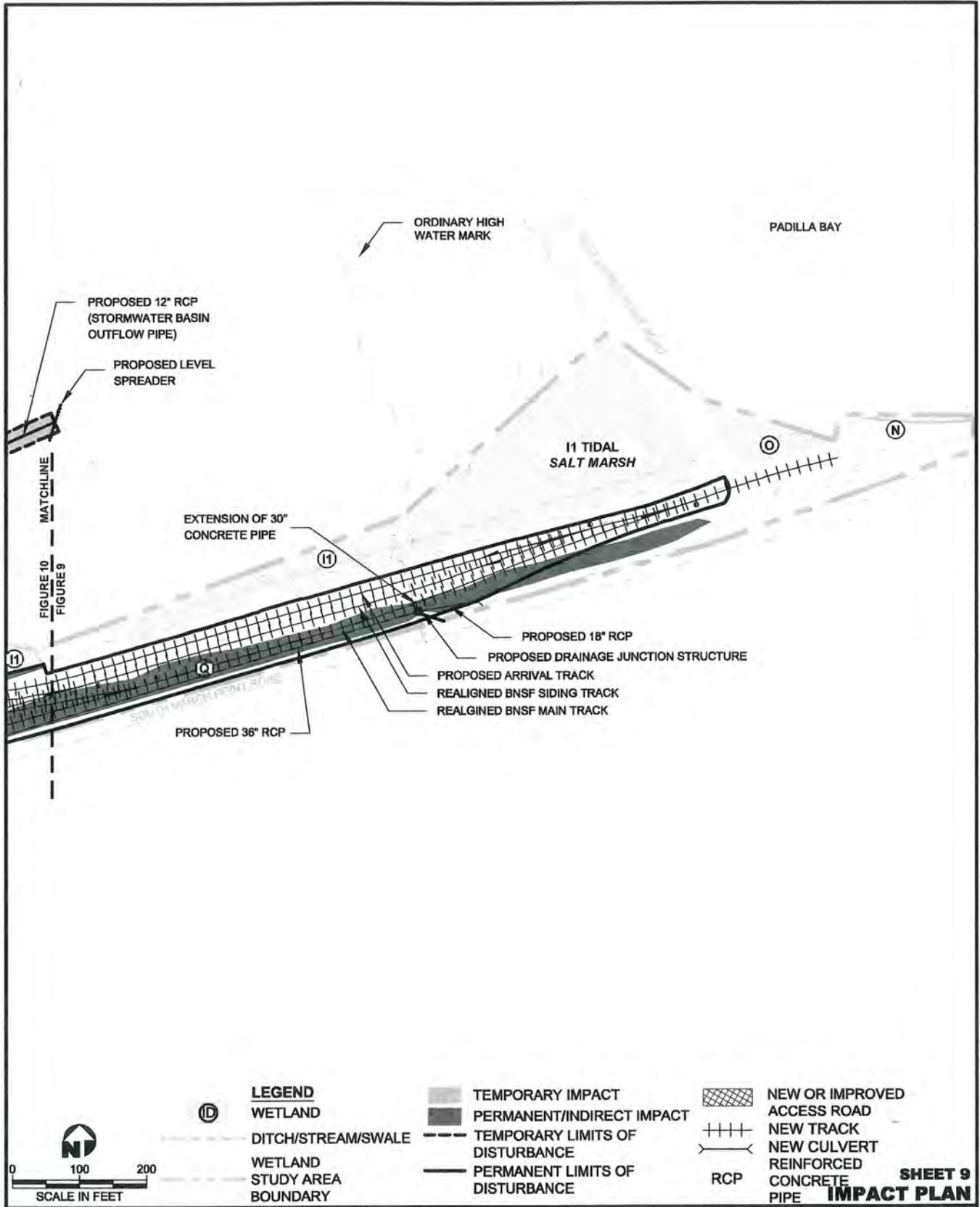

LEGEND

WETLAND	TEMPORARY IMPACT	NEW OR IMPROVED ACCESS ROAD
DITCH/STREAM/SWALE	PERMANENT/INDIRECT IMPACT	NEW TRACK
WETLAND STUDY AREA BOUNDARY	TEMPORARY LIMITS OF DISTURBANCE	NEW CULVERT
	PERMANENT LIMITS OF DISTURBANCE	REINFORCED CONCRETE PIPE



<p>Applicant: Shell</p> <p>Reference Number:</p> <p>Adjacent Property Owners: See Attachment C</p> <p>NWS-2013-1283</p>	<p>Project Address: 8505 South Texas Road Anacortes, WA 98221</p> <p>Lat/Long: Start: 48N-27-57, 122W-32-14 End: 48N-28-41, 122W-33-14</p> <p>Datum: Horizontal datum based on 'Shell Anacortes Refinery' local coordinate grid. Vertical Datum NAVD88.</p> <p>Sheet: 09 of 18 Date: 12/10/2013</p>	<p>Proposed Project: Crude by Rail East Gate</p> <p>In: Wetlands</p> <p>Near/At: Anacortes (Shell Puget Sound Refinery)</p> <p>County: Skagit</p> <p>State: WA</p>
---	---	---

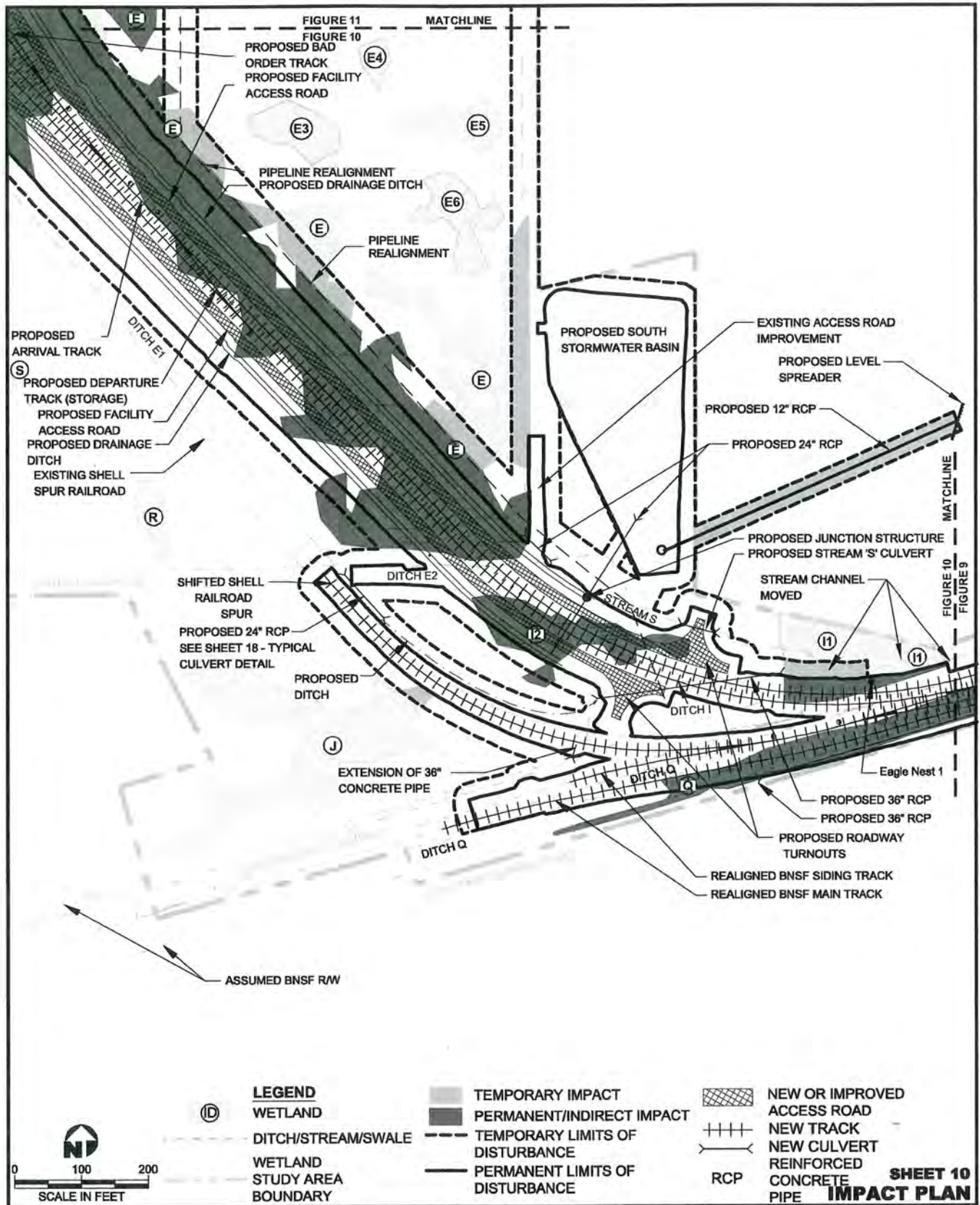

Applicant: Shell

Reference Number:

Adjacent Property Owners:
See Attachment C

NWS-2013-1283

Project Address: 8505 South Texas Road
Anacortes, WA 98221

Lat/Long: Start: 48N-27-57, 122W-32-14
End: 48N-28-41, 122W-33-14

Datum: Horizontal datum based on 'Shell Anacortes Refinery' local coordinate grid. Vertical Datum NAVD88.

Sheet: 10 of 18 **Date:** 12/10/2013

Proposed Project:
Crude by Rail East Gate

In: Wetlands

Near/At: Anacortes (Shell Puget Sound Refinery)

County: Skagit

State: WA

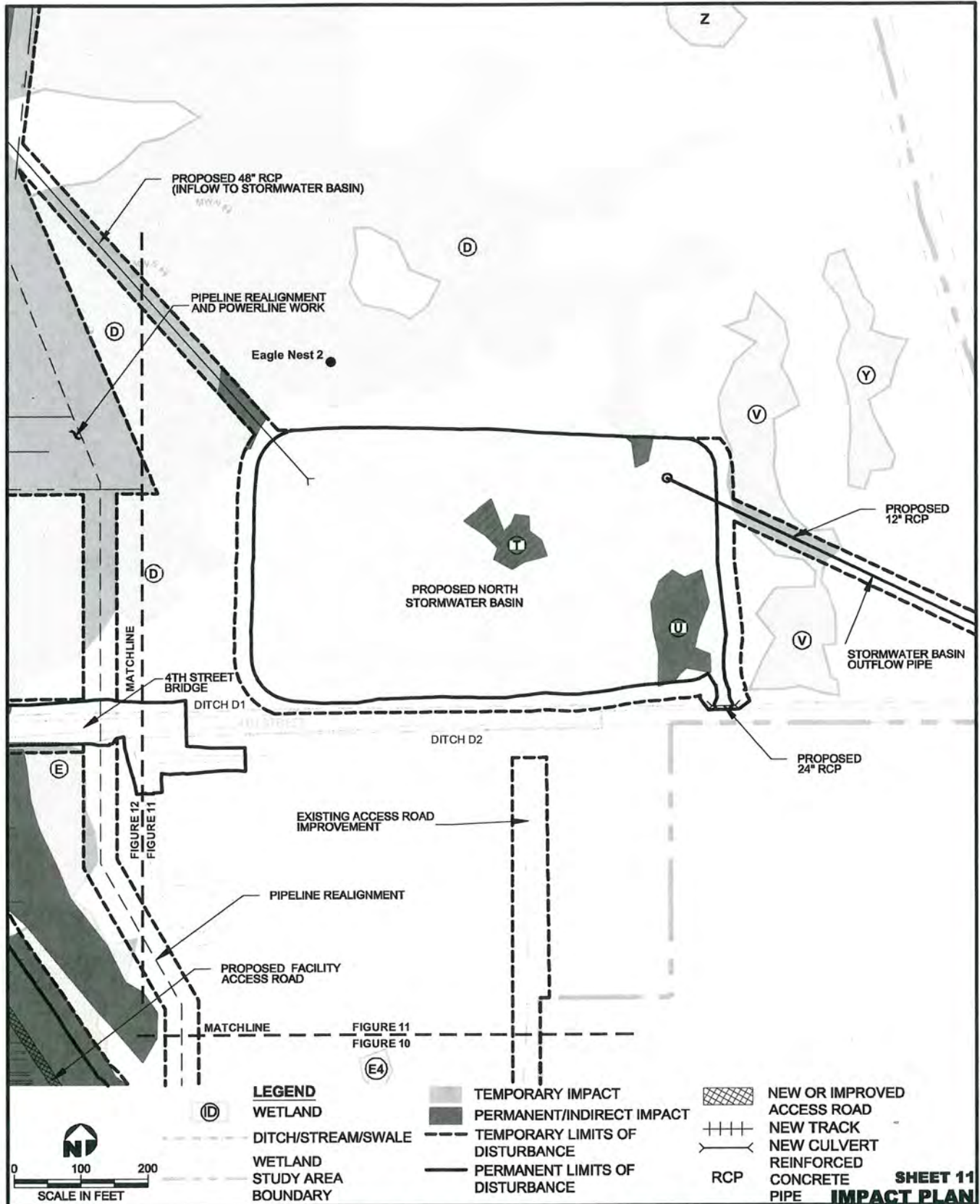

Applicant: Shell

Reference Number:

Adjacent Property Owners:
See Attachment C

NWS-2013-1283

Project Address: 8505 South Texas Road
Anacortes, WA 98221

Lat/Long: Start: 48N-27-57, 122W-32-14
End: 48N-28-41, 122W-33-14

Datum: Horizontal datum based on
'Shell Anacortes Refinery'
local coordinate grid.
Vertical Datum NAVD88.

Sheet: 11 of 18 **Date:** 12/10/2013

Proposed Project:
Crude by Rail East Gate

In: Wetlands

Near/At: Anacortes (Shell Puget Sound Refinery)

County: Skagit

State: WA

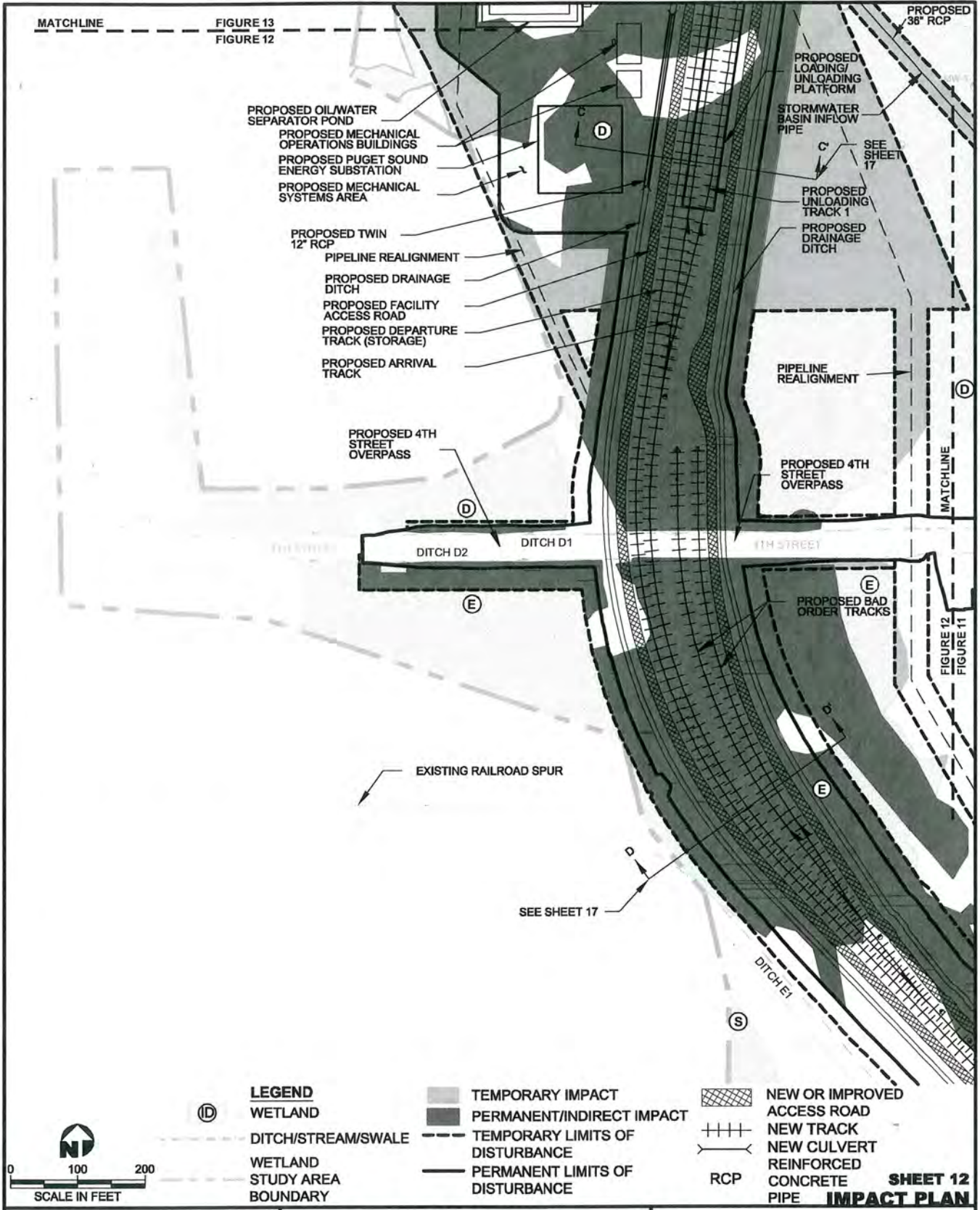

LEGEND					
	WETLAND		TEMPORARY IMPACT		NEW OR IMPROVED ACCESS ROAD
	DITCH/STREAM/SWALE		PERMANENT/INDIRECT IMPACT		NEW TRACK
	WETLAND STUDY AREA BOUNDARY		TEMPORARY LIMITS OF DISTURBANCE		NEW CULVERT
			PERMANENT LIMITS OF DISTURBANCE		REINFORCED CONCRETE PIPE
					RCP

SHEET 12
IMPACT PLAN

Applicant: Shell
Reference Number:
Adjacent Property Owners:
See Attachment C

NWS-2013-1283

Project Address: 8505 South Texas Road
Anacortes, WA 98221
Lat/Long: Start: 48N-27-57, 122W-32-14
End: 48N-28-41, 122W-33-14
Datum: Horizontal datum based on
'Shell Anacortes Refinery'
local coordinate grid.
Vertical Datum NAVD88.
Sheet: 12 of 18 **Date:** 12/10/2013

Proposed Project:
Crude by Rail East Gate
In: Wetlands
Near/At: Anacortes (Shell Puget Sound Refinery)
County: Skagit
State: WA

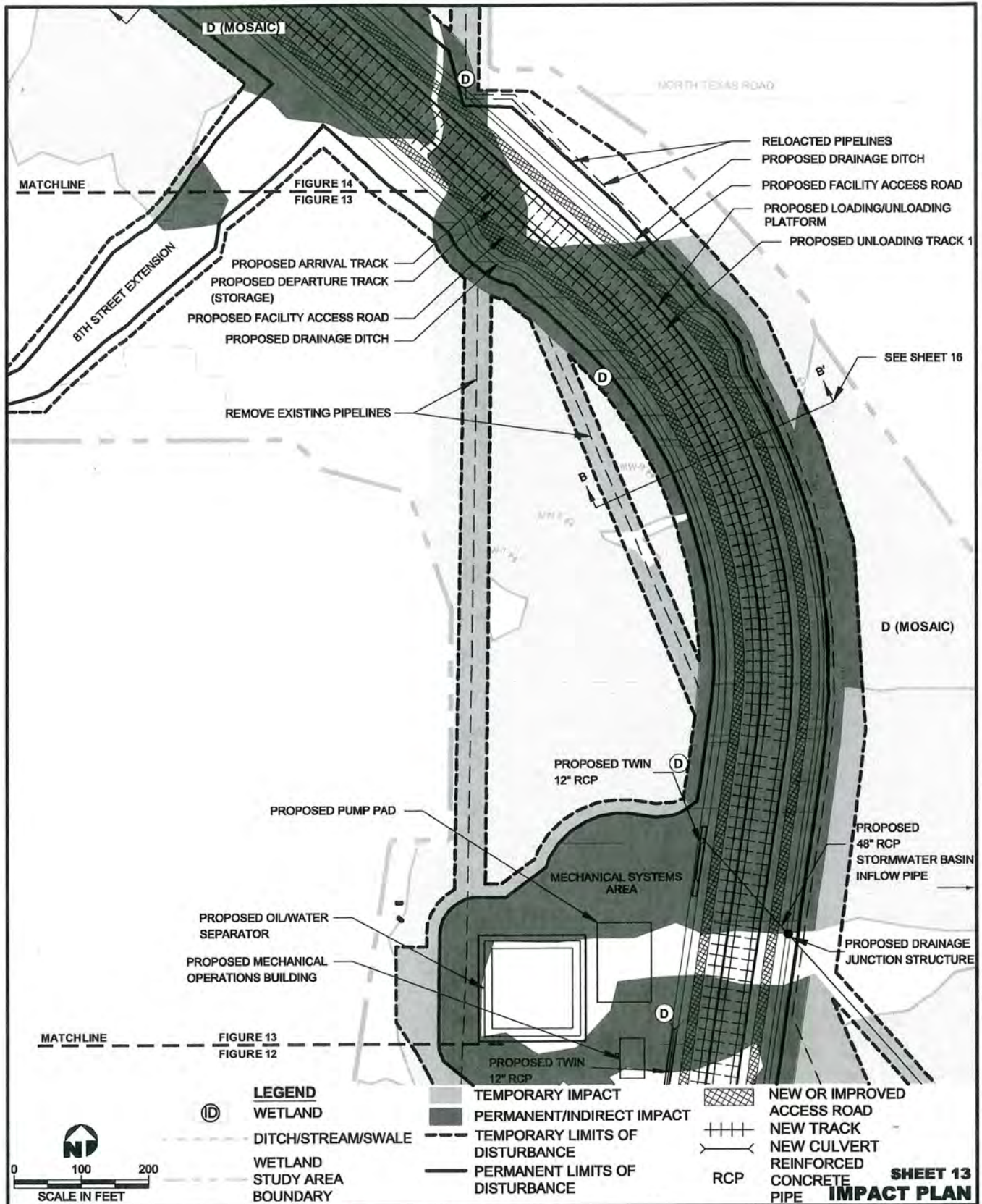

LEGEND

WETLAND	TEMPORARY IMPACT	NEW OR IMPROVED ACCESS ROAD
DITCH/STREAM/SWALE	PERMANENT/INDIRECT IMPACT	NEW TRACK
WETLAND STUDY AREA BOUNDARY	TEMPORARY LIMITS OF DISTURBANCE	NEW CULVERT
	PERMANENT LIMITS OF DISTURBANCE	RCP

<p>Applicant: Shell</p> <p>Reference Number:</p> <p>Adjacent Property Owners: See Attachment C</p> <p>NWS-2013-1283</p>	<p>Project Address: 8505 South Texas Road Anacortes, WA 98221</p> <p>Lat/Long: Start: 48N-27-57, 122W-32-14 End: 48N-28-41, 122W-33-14</p> <p>Datum: Horizontal datum based on 'Shell Anacortes Refinery' local coordinate grid. Vertical Datum NAVD88.</p> <p>Sheet: 13 of 18 Date: 12/10/2013</p>	<p>Proposed Project: Crude by Rail East Gate</p> <p>In: Wetlands</p> <p>Near/At: Anacortes (Shell Puget Sound Refinery)</p> <p>County: Skagit</p> <p>State: WA</p>
---	---	---

SHEET 13
IMPACT PLAN

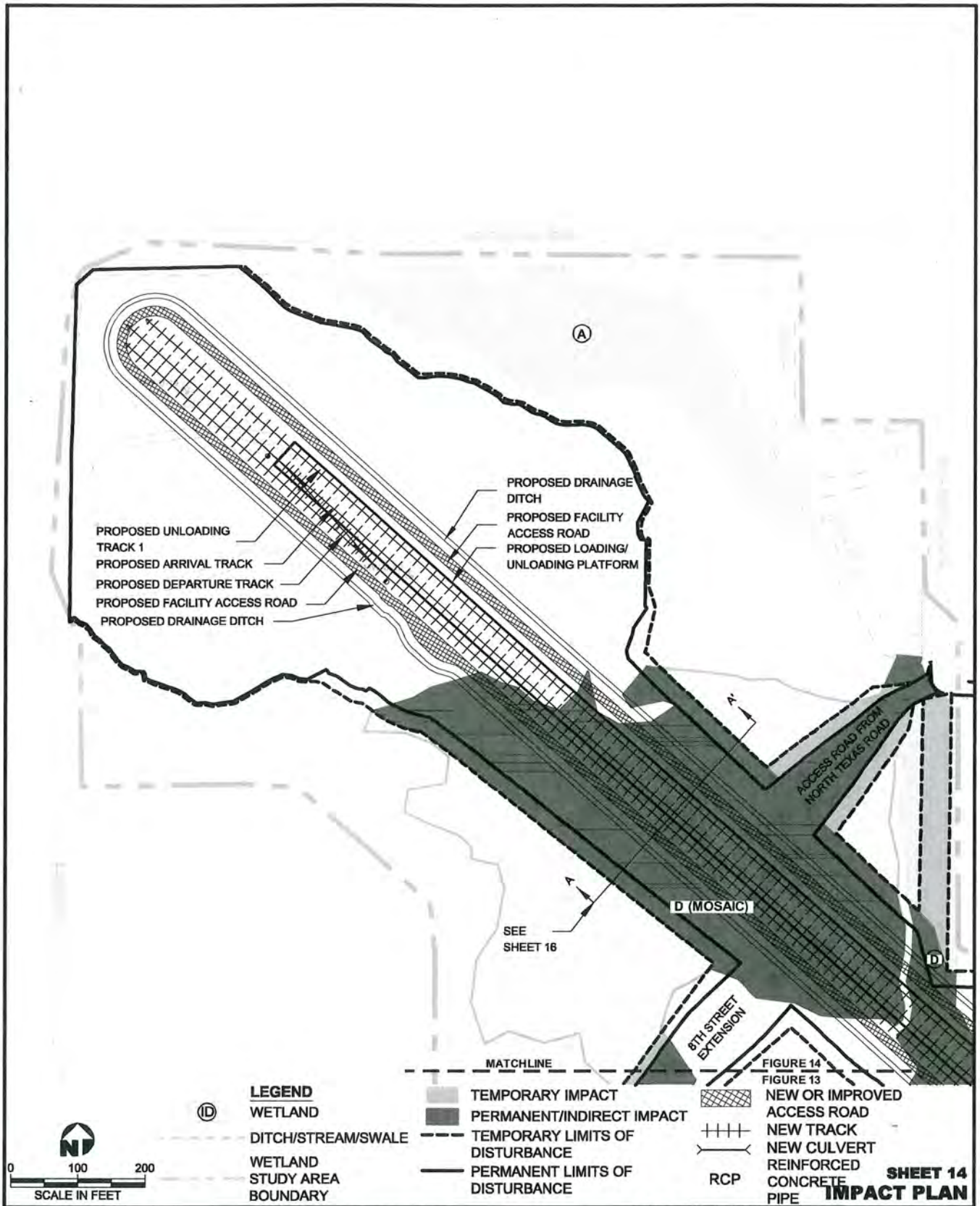

Applicant: Shell

Reference Number:

Adjacent Property Owners:
See Attachment C

NWS-2013-1283

Project Address: 8505 South Texas Road
Anacortes, WA 98221

Lat/Long: Start: 48N-27-57, 122W-32-14
End: 48N-28-41, 122W-33-14

Datum: Horizontal datum based on
'Shell Anacortes Refinery'
local coordinate grid.
Vertical Datum NAVD88.

Sheet: 14 of 18 **Date:** 12/10/2013

Proposed Project:
Crude by Rail East Gate

In: Wetlands

Near/At: Anacortes (Shell Puget Sound Refinery)

County: Skagit

State: WA

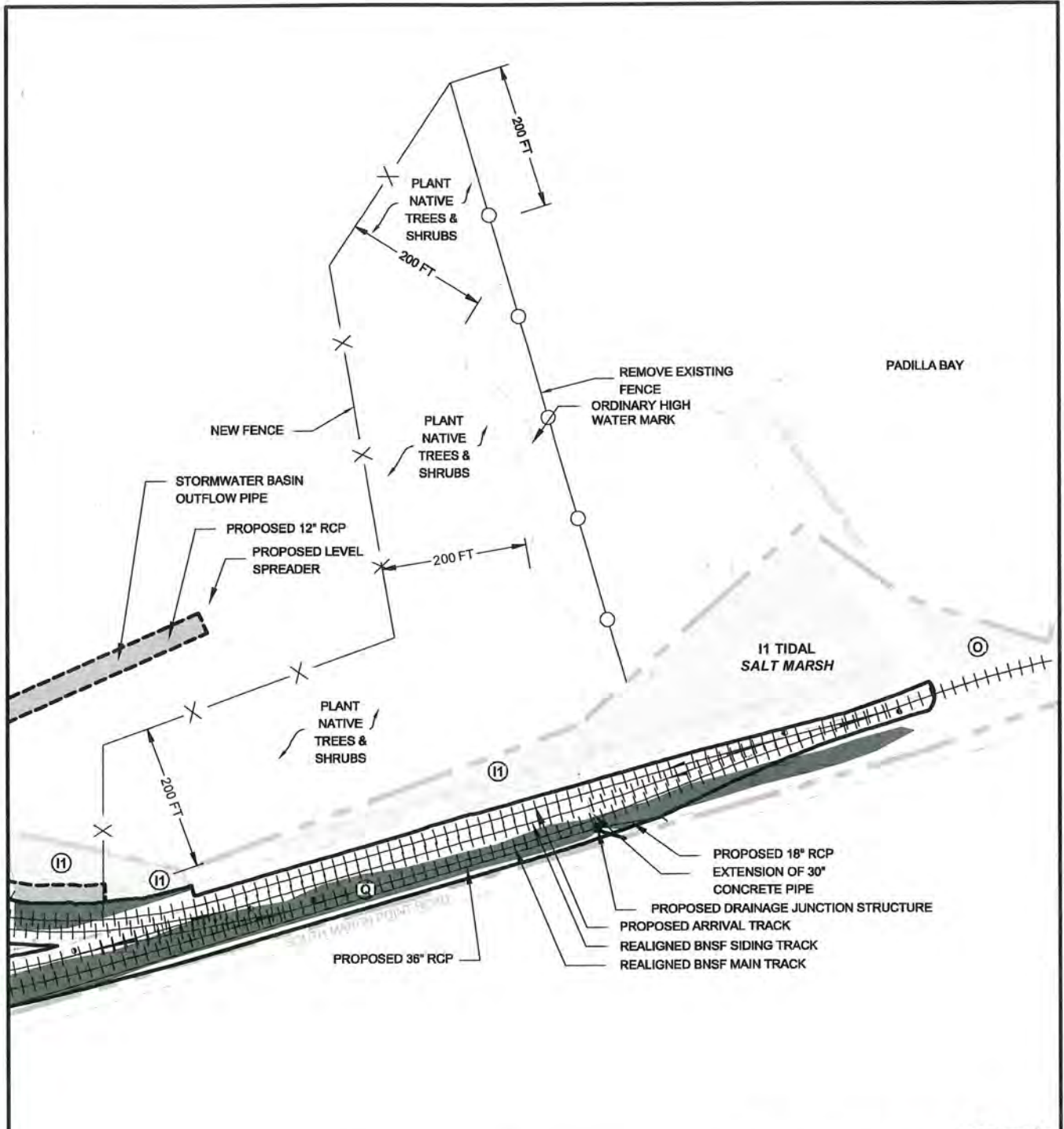

**SHEET 15
ONSITE RESTORATION PLAN**

 SCALE IN FEET	LEGEND WETLAND DITCH/STREAM/SWALE WETLAND STUDY AREA BOUNDARY	 TEMPORARY IMPACT PERMANENT/INDIRECT IMPACT TEMPORARY LIMITS OF DISTURBANCE PERMANENT LIMITS OF DISTURBANCE	 NEW OR IMPROVED ACCESS ROAD NEW TRACK NEW CULVERT RCP REINFORCED CONCRETE PIPE
-----------------------	---	---	--

Applicant: Shell
Reference Number:
Adjacent Property Owners:
 See Attachment C
NWS-2013-1283

Project Address: 8505 South Texas Road
 Anacortes, WA 98221
Lat/Long: Start: 48N-27-57, 122W-32-14
 End: 48N-28-41, 122W-33-14
Datum: Horizontal datum based on 'Shell Anacortes Refinery' local coordinate grid. Vertical Datum NAVD88.
Sheet: 15 of 18 **Date:** 12/10/2013

Proposed Project:
 Crude by Rail East Gate
In: Wetlands
Near/At: Anacortes (Shell Puget Sound Refinery)
County: Skagit
State: WA

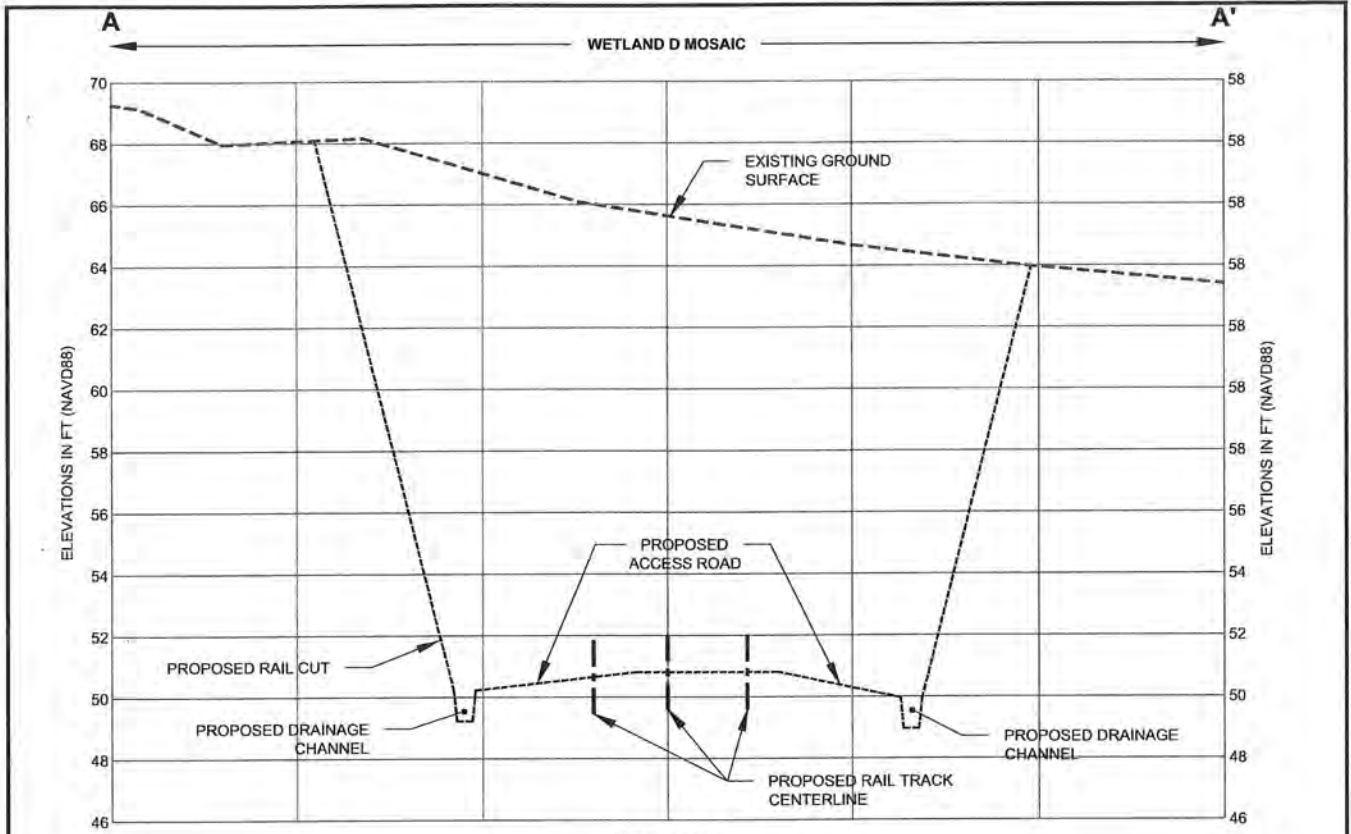

SECTION A

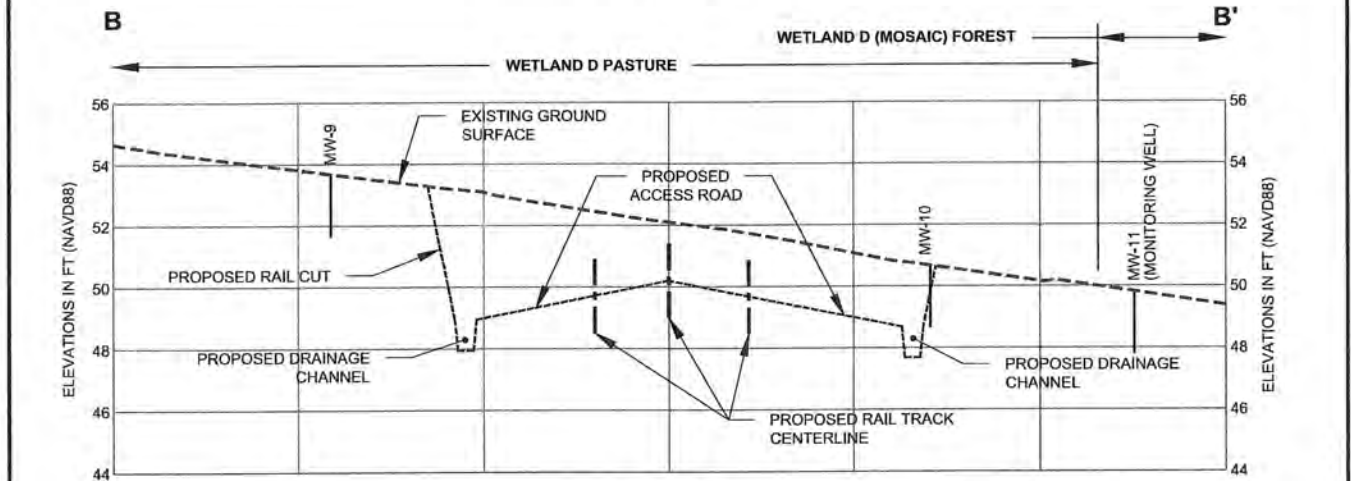

SECTION B

NOTE:
SECTIONS ARE EXAGGERATED 10 TIMES.

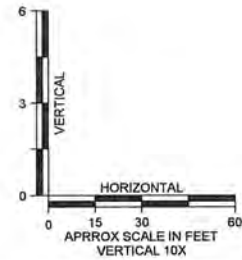

SHEET 16
SECTIONS

J:\GIS\Projects\SHELL\Puget Sound Refinery\SubTasks\Crude Rail\Wetland\Mitigation\JARP\AISheet_16-17 (Sections).dwg
Mod: 03/14/2014, 15:32 | Plotted: 03/17/2014, 15:42

Applicant: Shell
Reference Number:
Adjacent Property Owners:
See Attachment C
NWS-2013-1283

Project Address: 8505 South Texas Road
Anacortes, WA 98221
Lat/Long: Start: 48N-27-57, 122W-32-14
End: 48N-28-41, 122W-33-14
Datum: Horizontal datum based on
'Shell Anacortes Refinery'
local coordinate grid.
Vertical Datum NAVD88.
Sheet: 16 of 18 **Date:** 12/6/2013

Proposed Project:
Crude by Rail East Gate
In: Wetlands
Near/At: Anacortes (Shell Puget Sound Refinery)
County: Skagit
State: WA

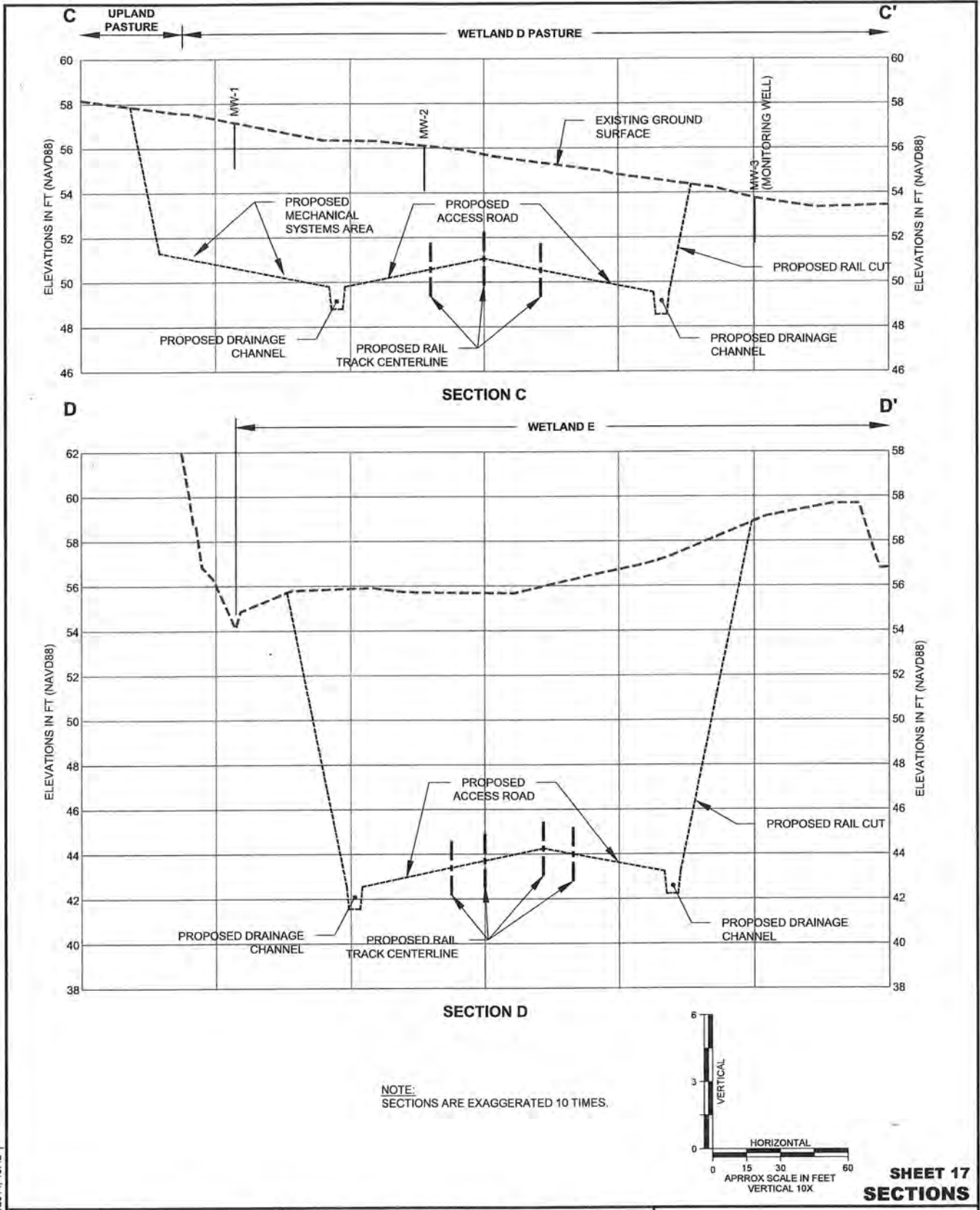

J:\GIS\Projects\SHELL\Puget Sound Refinery\SubTasks\Crude Rail\WetlandMitigation\JARP\A\Sheet_16-17 (Sections).dwg
 Mod: 03/14/2014, 15:32 | Plotted: 03/17/2014, 15:42

Applicant: Shell
Reference Number:
Adjacent Property Owners:
 See Attachment C
NWS-2013-1283

Project Address: 8505 South Texas Road
 Anacortes, WA 98221
Lat/Long: Start: 48N-27-57, 122W-32-14
 End: 48N-28-41, 122W-33-14
Datum: Horizontal datum based on
 'Shell Anacortes Refinery'
 local coordinate grid.
 Vertical Datum NAVD88.
Sheet: 17 of 18 **Date:** 12/6/2013

Proposed Project:
 Crude by Rail East Gate
In: Wetlands
Near/At: Anacortes (Shell Puget Sound Refinery)
County: Skagit
State: WA

SHEET 17
SECTIONS

J:\GIS\Projects\SHELL\Puget Sound Refinery\SubTasks\Crude Rail\Wetland\Mitigation\ARPA\Sheet 18 (Ditch Details).dwg
 Mod: 03/17/2014, 15:39 | Plotter: 03/17/2014, 15:39

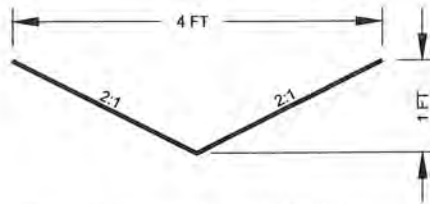

TYPICAL EXISTING DITCH DETAIL
 NOT TO SCALE

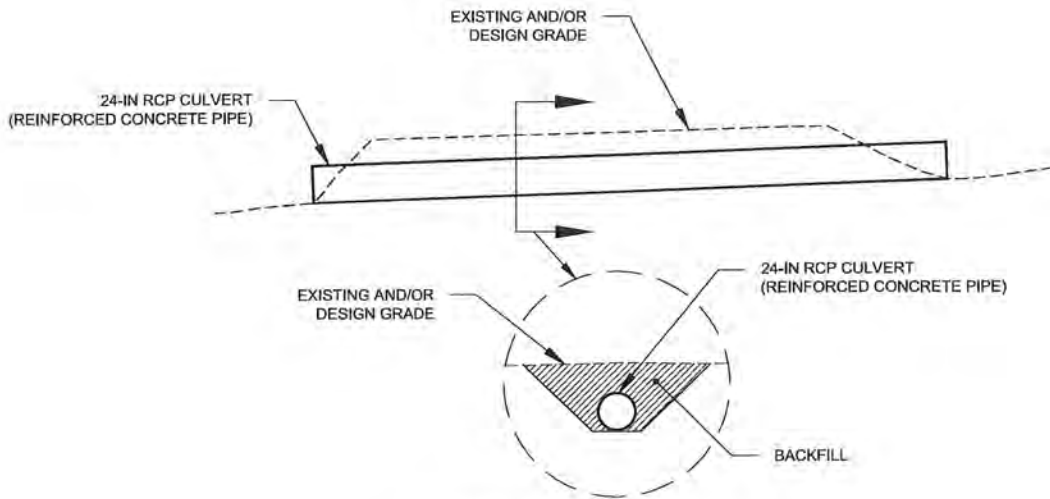

TYPICAL CULVERT DETAIL
 NOT TO SCALE

SHEET 18
TYPICAL DITCH AND CULVERT DETAILS

<p>Applicant: Shell</p> <p>Reference Number:</p> <p>Adjacent Property Owners: See Attachment C</p> <p>NWS-2013-1283</p>	<p>Project Address: 8505 South Texas Road Anacortes, WA 98221</p> <p>Lat/Long: Start: 48N-27-57, 122W-32-14 End: 48N-28-41, 122W-33-14</p> <p>Datum: Horizontal datum based on 'Shell Anacortes Refinery' local coordinate grid. Vertical Datum NAVD88.</p> <p>Sheet: 18 of 18 Date: 12/6/2013</p>	<p>Proposed Project: Crude by Rail East Gate</p> <p>In: Wetlands</p> <p>Near/At: Anacortes (Shell Puget Sound Refinery)</p> <p>County: Skagit</p> <p>State: WA</p>
--	---	--